

PURE WATER PERFECT SHINE

Spot-free rinse
No wiping
No watermarks

PurePro[®] **AW-400X**

Ultra-Pure RO-DI Water System
USER'S MANUAL

PUREPRO
DRINKING WATER SYSTEM

© PUREPRO USA CORP., ILLINOIS, U.S.A.

Thank you very much for selecting Pure-Pro Water Corp.

To get the best performance from your system, please read the user's manual carefully before installation and follow all safety regulations.



System overview



■ AW-400X

Cartridge filters



5M PP Filter

This 5micron sediment filter is made of 100% pure polypropylene fibers. High capacity filter removes dusts, particles and rusts.

Service Life : 3 Months



Block Carbon Filter

This block carbon filter is composed of high-performance carbon that removes free chlorine, odor, organic contaminants, pesticides and chemicals that contributed to taste and odor.

Service Life : 3 Months



Block Carbon Filter

This block carbon filter is composed of high-performance carbon that removes free chlorine, odor, organic contaminants, pesticides and chemicals that contributed to taste and odor.

Service Life : 3 Months



**200GPD TFC Membrane
2 pcs**

200 Gallon Per Day Membranes are now available in residential sizes. Designed to perform in operating conditions similar to most standard under-the-counter home RO units, the TW30-1812-200 forms a tight fit in most standard residential housings.

Service Life : 1 Year



DI Filter

Produce 99.99% pure water by simply attaching this convenient deionization filter with RO unit. Convenient post RO filtration DI unit (RO / DI unit) provides crucial supplemental filtration to remove most impurities for pure polished product water. Excellent in areas with hard water. Produce 99.99% pure water. It will give you 0 ppm TDS, Conductivity attainable less than 0.1uS/cm or resistivity of close to 18 meg.ohm

Service Life : 1 Month

Components

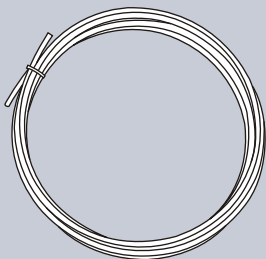

Tubing

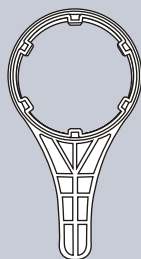

Housing wrench

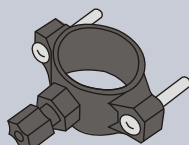

Drain saddle

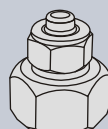

Feed water connector

Selections

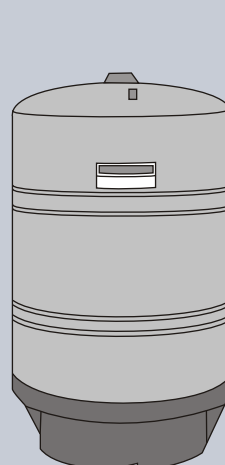

20G water storage tank

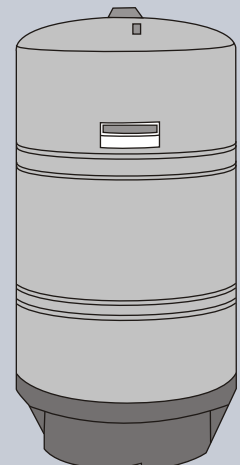

28G water storage tank

Tubing connection diagram

■ Connecting the color tubing

- A. Connect the WHITE tubing to the water supply connector (usually from your tap or inlet valve).
- B. Connect the YELLOW tubing to the pressurized water storage tank.
- C. Connect the ORANGE tubing to the drain saddle (used for wastewater discharge).

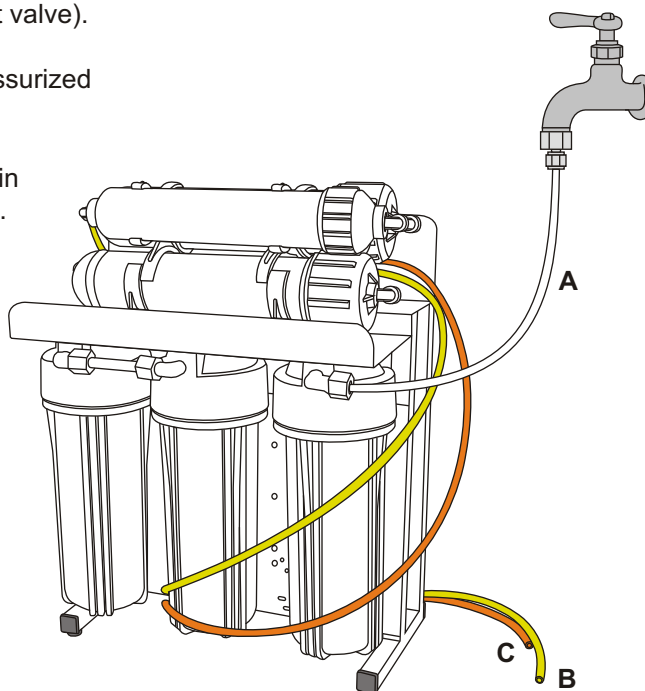

Installation diagram

Install drain saddle :

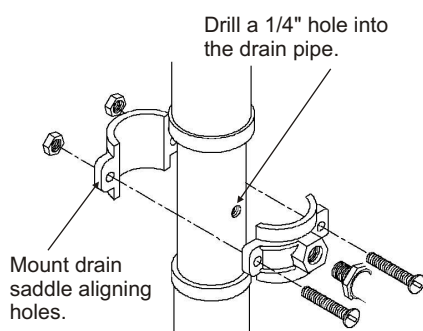

Install membrane :

- Remove the tube.

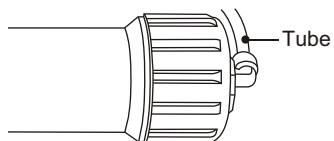

- Remove the membrane housing cap.
- Install the membrane by carefully pushing the spigot end into the socket at the far end of the housing until completely in.

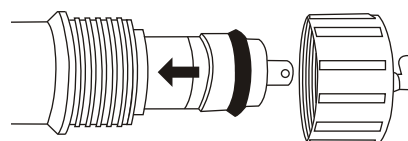

Installation diagram

1. Connect the white tubing to the inlet water supply and the delivery valve.

1

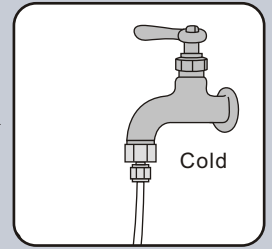
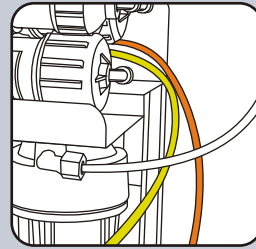

2. Connect the orange tubing to the drain saddle.

2

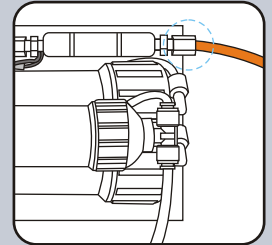
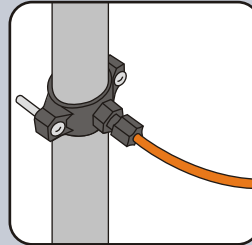

3. Connect the yellow tubing to the storage tank.

3

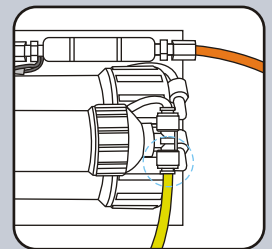
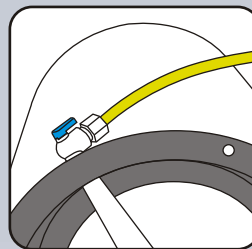

4. Once all connections are secure, turn on the water supply and plug in the power.

4

PURE WATER RINSING IS SAFE & EFFORTLESS



Change filters

Change stage 1, 2, 3

- 1 Before filter replacement, please make sure water and electricity supply are cut off. Please turn off the tank ball valve, too.
- 2 To loosen the housings, please use the wrench and rotate close-wise.
- 3 To tighten the housing, please use the wrench and rotate anti-clockwise.

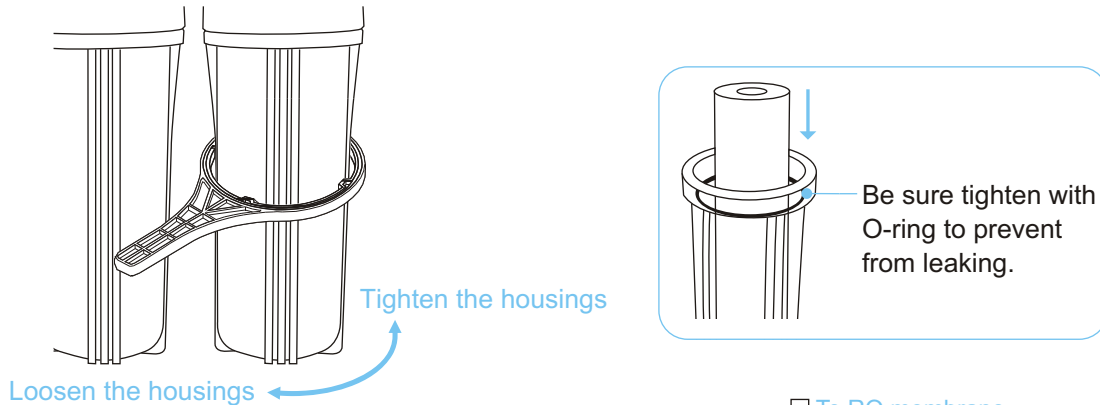

Change stage 6

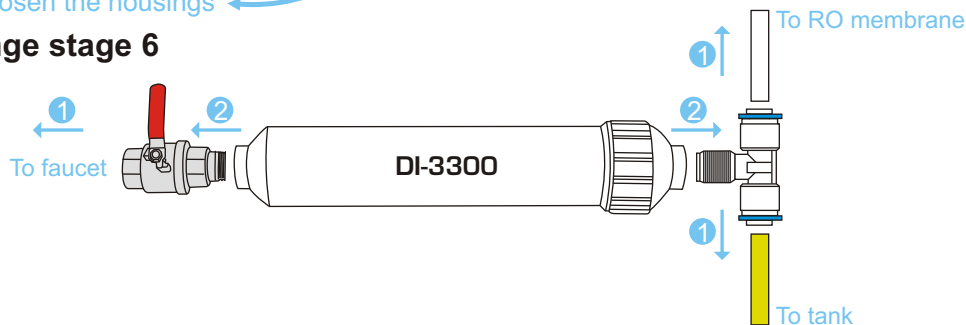

- 1 Before filter replacement, please make sure water and electricity supply are cut off. Please turn off the tank ball valve, too.
- 2 Filters carry direction of water flow. Please make sure the correct flow direction during installation.
- 3 Loosen the quick fitting on both ends to replace the filter.
- 4 To avoid leakage, please tighten the quick fitting with Teflon tape before filter replacement.

Change RO membrane

Change stage 4, 5

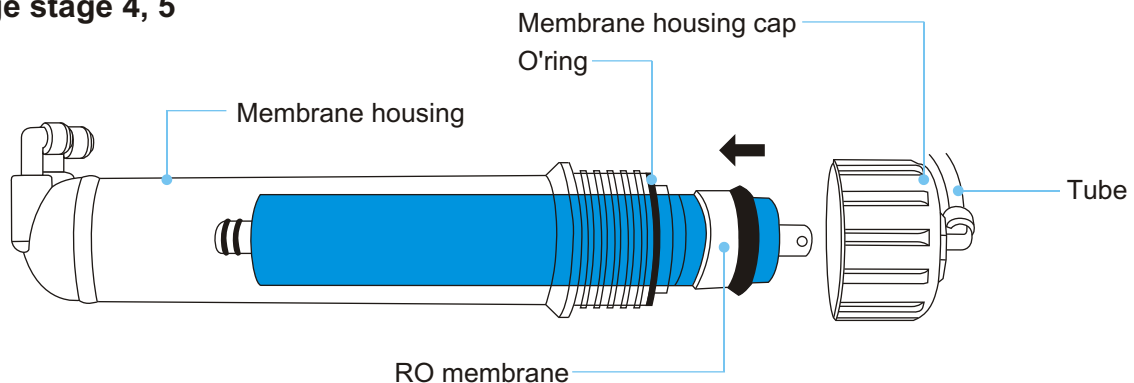

- 1 Before filter replacement, please make sure water and electricity supply are cut off. Please turn off the tank ball valve, too.
- 2 Remove the tube.
- 3 Remove the membrane housing cap anticlockwise.
- 4 Remove the membrane by a pincer.
- 5 Install the membrane by carefully pushing the spigot end into the socket at the far end of the housing until completely in.
- 6 Be sure tighten with O-ring to prevent from leaking.

※ After changing filters, let water run for about 15 minutes to clear the filters.

Operation regulation

- A. With everything connected, turn on the water check for leaks.
- B. Make sure the storage tank shut-off valve is "OFF". Open the sink top faucet.
- C. Within a few minutes (up to 15) the water will start to run from the faucet slowly.
- D. Let the water run for at least 30 minutes. This flushes the carbon filters on first time use.
- E. After initial flushing, open the shut-off valve on the tank and close the sink top faucet.
- F. Tank will now full of water (usually 2 to 3 hours) after the tank has filled.
Open the sink top faucet and drain all water until the storage tank is empty and there is only a small flow from the sink top faucet. *** DO NOT USE FIRST TANK OF WATER. ***
- G. Close the sink top faucet. The system is now ready for use.
- H. Change filters regularly every 6 to 12 months and have the membrane checked annually.

Caution

- 1. Do not use hot water (over 45°C)!
- 2. Do not freeze the machine!
- 3. Switch off electricity and water source if away for more than 5 days, and drain out pure water.

Warranty

Type of product			
Date of purchase			
Name		Tel	
Address			
<p>★ If the supply cord is damaged, it must be replaced by a special cord or assembly available from the manufacturer or its service agent.</p>			

Pure-Pro Reverse Osmosis (RO) Systems

Over ten years expertise in reverse osmosis drinking water systems, our unique design features make installation easier and operation more reliable, and our wide selection of colors and sizes allows you to solve virtually any RO application.

PUREPRO
DRINKING WATER SYSTEM

© PUREPRO USA CORP., ILLINOIS, U.S.A.

Pure-Pro Water Corporation

19636 S. 97th Ave Mokena, Illinois, U.S.A.
Tel: +1 708 479 4473 Fax: +1 708 479 4332

 www.purepro.net